

KRS-3 SERIES

DESCRIPTIONS:

- Pressure switch used in water systems.
- The switch start and stop the water pump automatically according to the setting pressure.
- Hydraulics connection can choose: 1/4" & 3/8" Female.
- Customized setting.



OPTIONALS:

- Hydraulics connection according to customers' needs.
- Pressure setting according to customers' needs.

KRS-4 SERIES

DESCRIPTIONS:

- Pressure switch used in water systems.
- The switch start and stop the water pump automatically according to the setting pressure.
- Hydraulics connection can choose: 1/4" & 3/8" Female.
- Customized setting.



OPTIONALS:

- Hydraulics connection according to customers' needs.
- Pressure setting according to customers' needs.

KRS-3 TECHNICAL PARAMETERS:

Rated Voltage	230V;110V
Power Frequency	50/60HZ
Rated Current	12A/15HP;20A/2HP
Min.cut-in	20PSI
Max.cut-out	120PSI
Pressure Range	20-40PSI;30-50PSI;40-50PSI;50-70PSI <i>(According To Requirements Of Customers)</i>
Contacts	Silver/Copper
Cover Color	Grey/black
Cover Shape	Steel Fixed/Plastic Fixed/American Standard
Base Color	Color Plate/White Plated
Flange	Steel/Plastic
Screw Type	Female Male
Screw Size	Fix Nut:1/4";3/8" Rotary:1/4";3/8" 1/4"

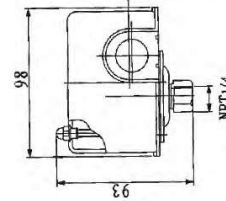

KRS-4 TECHNICAL PARAMETERS:

Rated Voltage	230V;110V
Power Frequency	50/60HZ
Rated Current	12A/15HP;20A/2HP
Min.cut-in	20PSI
Max.cut-out	120PSI
Pressure Range	20-40PSI;30-50PSI;40-60PSI;50-70PSI <i>(According To Requirements Of Customers)</i>
Contacts	Silver/Copper
Cover Color	Grey/black
Cover Shape	Steel Fixed/Plastic Fixed/American Standard
Base Color	Color Plated/White Plated
Flange	Steel/Plastic
Screw Type	Female Male
Screw Size	Fix Nut:1/4";3/8" Rotary:1/4";3/8" 1/4"

